



## High pressure filters

- Keep your hydraulic system clean
- Pleated stainless steel wire mesh screen construction provides large filter area in a compact size
- Rated for full system pressure up to 350 bar
- Bi-directional design allows filtration of oil in either flow direction
- Two piece body construction for easy replacement of filter elements
- High flow rates are obtainable with a minimum pressure drop
- Threaded port connections on each end simplify installation

## Hydraulic oil

- Ensures effective lubricity
- Protects essential parts

## Filtration

**20 micron filter** provides the longest service life before element replacement.

**10 micron filter** recommended for more sensitive hydraulic components.

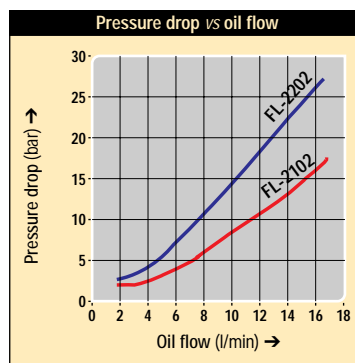

## FL series

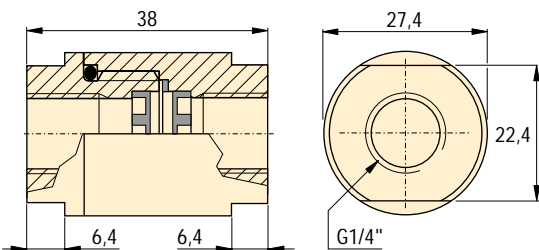

## High pressure filters (350 bar)

| Model number | Filtration |          | Model number<br>Filter element set |     |
|--------------|------------|----------|------------------------------------|-----|
|              | Nominal    | Absolute |                                    |     |
|              | micron     |          |                                    |     |
| FL-2102      | 10         | 25       | FL-2101K                           | 0,2 |
| FL-2202      | 20         | 40       | FL-2201K                           | 0,2 |

## Hydraulic oil

| Contents | Model number | Specifications<br>genuine Enerpac<br>hydraulic oil |               |               |           |
|----------|--------------|--|---------------|---------------|-----------|
| litres   |              |  |               |               |           |
| 1,0      | HF-95X       | 0 °C   | < 1500 cSt    | Flash, C.O.C. | 210 °C    |
| 5,0      | HF-95Y       | 37,8 °C  | 32 - 34 cSt   | Pour point    | -32 °C    |
| 60,0     | HF-95Z       | 100 °C   | 5,0 - 6,1 cSt | Aniline point | 99/104 °C |

Note: Viscosity index: 100 min

- E** Mangueras, Filtros  
Acoplamiento, Aceite
- F** Flexibles, Filtres  
Raccords, Huile
- D** Schläuche, Filter  
Kupplungen, Öl

## High pressure filters

Compact inline high pressure filters prevent chips and debris that have entered the hydraulic fluid system from damaging hydraulic system components.

## Hydraulic oil

Use only genuine Enerpac hydraulic oil to guarantee optimal performance and long life of your hydraulic equipment.

## Options

### Fittings

110 ▶



## Important

**Do not exceed the maximum pressure.**

■ Hydraulic power is distributed by manifolds and transported by hoses and tubing.

